

# USB Female Reverse Flat Dip 90° A Type

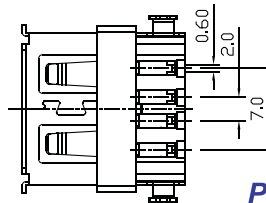
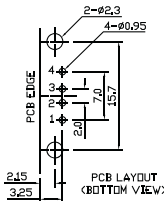
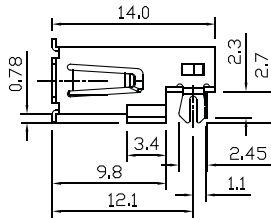
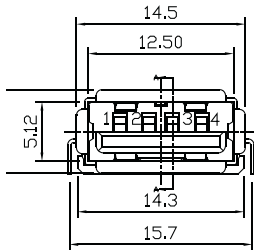

Part No.:USB-001RD-A1□-L

B:Black W:White

No.	Name	Material	Finish	Q'TY	Remark
1	Housing	PBT G.F.	Black/White	1	
2	Terminal	Phos. Bronze T=0.25	Gold/Tin Plated	4	Gold:1~3 $\mu$ m; Ni:40~60 $\mu$ m; Tin:120 $\mu$ m (100% pure Tin of lead free plating)
3	Shell	Brass T=0.3	Nickel Plated	1	Ni:80~120 $\mu$ m